

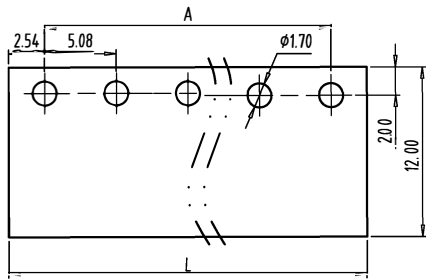

Phoenix 1924088 Alternative

Pluggable Terminal Blocks 2 Pos 5.08mm pitch Through Hole Header



PCB LAYOUT
S=2.5:1

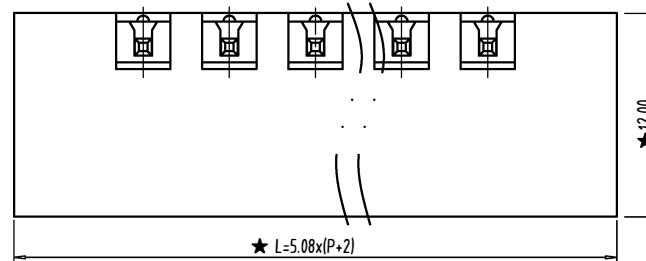

NOTES:

1. Rating: 300V 15A ;
2. Insulation Withstands Voltage: AC2000V/MIN
3. Insulation Resistance: 500MΩ or more at DC500V
4. Using Temperature Range: -40°C~+105°C
5. "★" is the important dimension

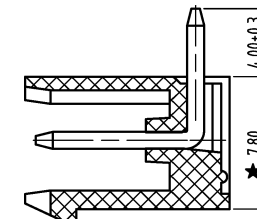
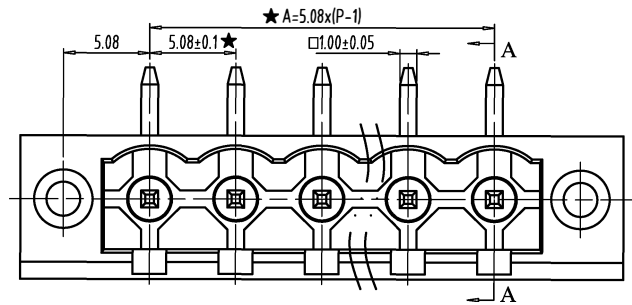
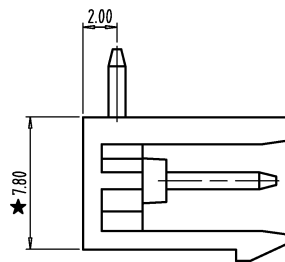

SECTION: A-A

Total Pitch Tolerances in mm										Nominal dimension range in mm										⊥	≡	-	//									
over 0	over 30	over 53	over 70	over 90	over 115	over 150	over 250	over 350	over 500	over 0	over 30	over 53	over 70	over 90	over 115	over 150	over 200	over 250	over 320	over 0	over 10	all	over 0	over 100	over 150	over 150	0.2	0.3	0.3	0.2	0.3	0.5
±0.18	±0.20	±0.25	±0.3	±0.35	±0.44	±0.60	±0.70	±0.85	±0.20	±0.25	±0.30	±0.35	±0.44	±0.55	±0.70	±0.80	±0.90	0.2	0.3	0.3	0.2	0.3	0.5									

ITEM	NAME OF PART	NO. OF PART	Q'TY	MATERIAL	NOTE
DWG.	SK	DATE	2014-11-20	SIZE	A4 UNITS mm SHEET/OF 1/1
CHK.		DATE		SCALE	3:1 5.08
APP.		DATE		NAME	Phoenix 1924088 Alternative
BEC Distribution Limited				DWGNO.	1924088