

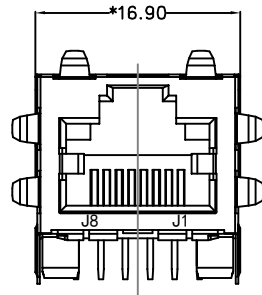

08B1-1X1T-06-F alternative
CONN JACK 1PORT 100 BASE-T PCB

| REV. | ECN / DESCRIPTION | BY | DATE |
|------|-------------------|-------|------------|
| A0 | NEW | ZG.Hu | 2017.11.16 |



FRONT VIEW

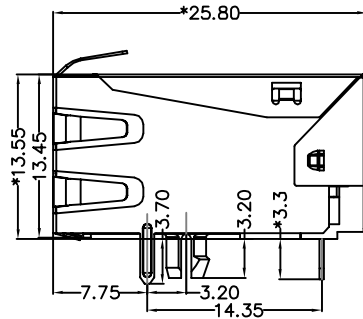

RIGHT SIDE VIEW

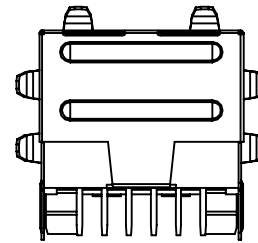

BACK VIEW

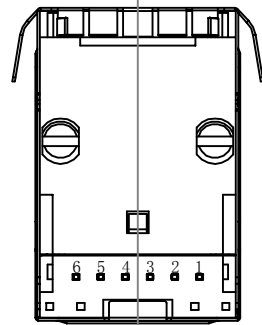

BOTTOM VIEW

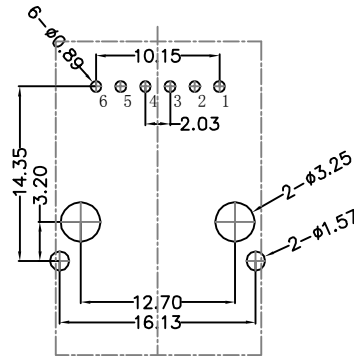

RECOMMENDED PCB LAYOUT
VIEWED FROM COMPONENT SIDE

MATERIAL:

HOUSING: PA66,UL94V-0,BLACK.
TERMINALS BRACKET: PA66,UL94V-0,BLACK.
SHIELD: C2680,T=0.20MM,NICKEL PLATING ON ALL AREA.
TERMINAL: PHOSPHOR BRONZE C5210,T=0.35MM,
6U" GOLD PLATING ON CONTACT AREA.

MECHANICAL:

DURABILITY: 750 CYCLES MIN.
MATING FORCE: 23N MAX.
OPERATING TEMPERATURE: -40°C~+85°C.
STORAGE TEMPERATURE: -40°C~+85°C.
ALL CRITICAL DIMENSIONS WITH "*"

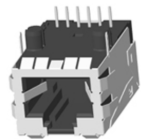

Bell Fuse 08B1-1X1T-06-F alternative

By:



www.bec.co.uk

1 Port RJ45 Magjack Connector Through Hole
10/100 Base-T, AutoMDIX

TITLE:
TAB-UP 1X1 100BASE

PART NO.:
BCE311B031HWA5D

REMARK:

SIZE
A4
UNITS
MM[INCH]

SACLE
1:1
REV
A0

SHEET
1/3

GENERAL TOLERANCES
UNLESS SPECIFIED

| | |
|-----------|------------|
| x±0.35 | x°±3.0° |
| .x±0.30 | .x°±2.0° |
| .xx±0.25 | .xx°±1.5° |
| .xxx±0.10 | .xxx°±1.0° |

APPROVED BY:
JP.Gong

CHECKED BY:
TW.Xu

DESIGND BY:
ZG.Hu



08B1-1X1T-06-F alternative
CONN JACK 1PORT 100 BASE-T PCB

| REV. | ECN / DESCRIPTION | BY | DATE |
|------|-------------------|-------|------------|
| A0 | NEW | ZG.Hu | 2017.11.16 |

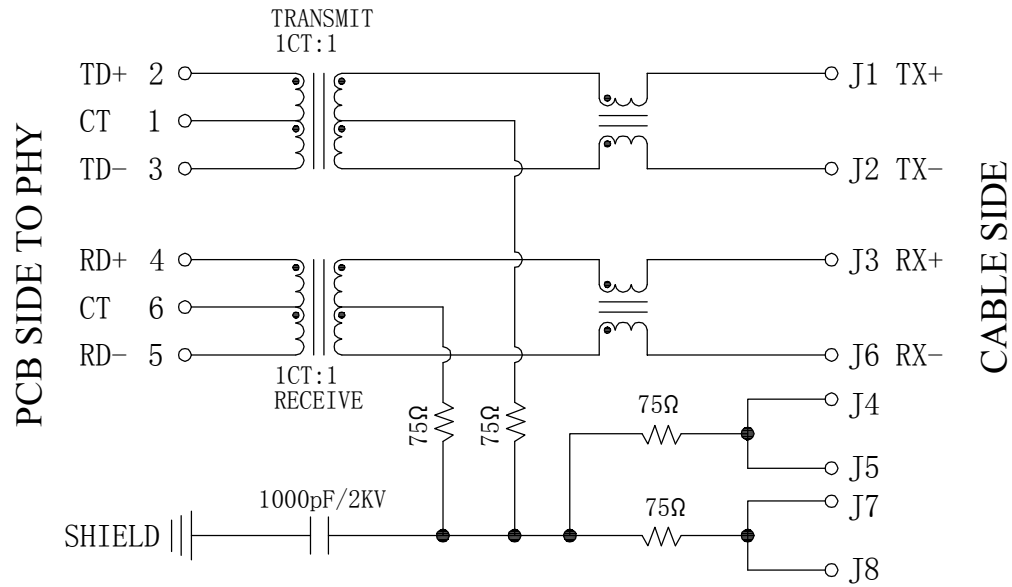

Electrical:

- Turn ratio: 2~3: J1~J2=1CT:1CT(±2%).
4~5: J3~J6=1CT:1CT(±2%).
- OCL: 350uH Min. at 100KHz 100mV 8mA DC.
- Insertion Loss: -1.0 dB Max 1~100MHz.
- Return loss: -20dB Min 1~10MHz;
-16dB Min 10~30MHz.
-12dB Min 30~60MHz.
-10dB Min 60~80MHz.
- Cross talk: -40dB Min 1~30MHz;
-35dB Min 30~60MHz;
-30dB Min 60~100MHz;
- CMR: -30dB Min 1~100MHz;
- Hi-Pot: 1500V AC & 2250V DC
6S 1mA PRI TO SEC



Bell Fuse 08B1-1X1T-06-F alternative

By:  www.bec.co.uk
1 Port RJ45 Magjack Connector Through Hole
10/100 Base-T, AutoMDIX

TITLE:
TAB-UP 1X1 100BASE

PART NO.:
BCE311B031HWA5D

REMARK:

SIZE
A4

SACLE
1:1

SHEET
2/3

UNITS
MM[INCH]

REV
A0

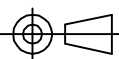

GENERAL TOLERANCES
UNLESS SPECIFIED

| | |
|-----------|------------|
| x±0.35 | x°±3.0° |
| .x±0.30 | .x°±2.0° |
| .xx±0.25 | .xx°±1.5° |
| .xxx±0.10 | .xxx°±1.0° |

APPROVED BY:
JP.Gong

CHECKED BY:
TW.Xu

DESIGND BY:
ZG.Hu



PROFILE OF WAVE SOLDER

| REV. | ECN / DESCRIPTION | BY | DATE |
|------|-------------------|-------|------------|
| A0 | NEW | ZG.Hu | 2017.11.16 |

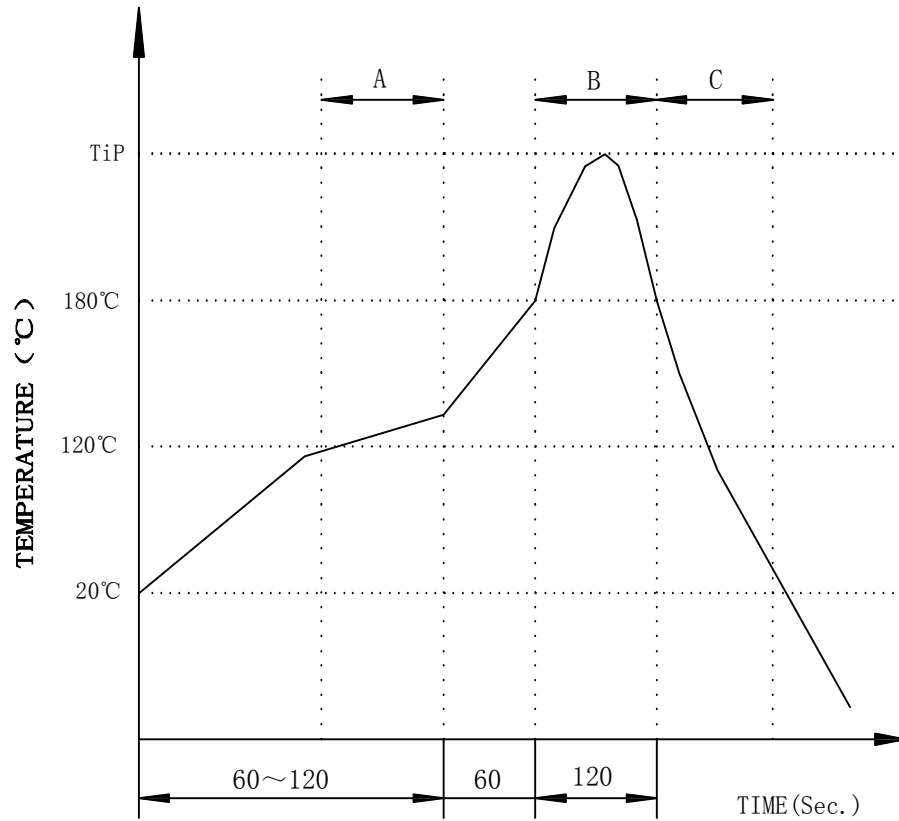

A.Preheating B.Soldering C.Gradual Cooling
 Tip temperature:260±5°C.
 Tip temperature time:5Sec Max.
 Tip melting point of Sn96.5/Ag3/Cu0.5:217°C.

Remarks: after wave soldering, the plastic positioning columns of the product which under the PCB will be slightly melted, but it won't affect its function.

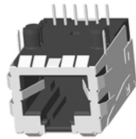

Bell Fuse 08B1-1X1T-06-F alternative

By:  www.bec.co.uk

1 Port RJ45 Magjack Connector Through Hole
 10/100 Base-T, AutoMDIX

TITLE:
TAB-UP 1X1 100BASE

PART NO.:
BCE311B031HWA5D

REMARK:

SIZE
A4
UNITS
MM[INCH]

SACLE
1:1
REV
A0

SHEET
3/3

GENERAL TOLERANCES
UNLESS SPECIFIED

| | |
|-----------|------------|
| x±0.35 | x°±3.0° |
| .x±0.30 | .x°±2.0° |
| .xx±0.25 | .xx°±1.5° |
| .xxx±0.10 | .xxx°±1.0° |

APPROVED BY:
JP.Gong

CHECKED BY:
TW.Xu

DESIGND BY:
ZG.Hu