

Coilcraft XAL5020 alternatives

SEP5020HS SERIES High Current SMD

Shielded Power Inductors



Coilcraft		BEC alternative	Inductance (μH)	Isat (A) (Typ.)	Irms (A) (Typ.)	DCR (m Ω) (Typ.)	DCR (m Ω) (Max.)
XAL5020-161ME	>	Available upon request	0.16				
XAL5020-331ME	>	Available upon request	0.33				
		SEP5020HS-R47M-LF	0.47	13.3	11	6.0	7.2
XAL5020-561ME	>	Available upon request	0.56				
XAL5020-801ME	>	Available upon request	0.80				
		SEP5020HS-1R0M-LF	1.0	8	7.6	11.5	13.5
XAL5020-122ME	>	Available upon request	1.2				
		SEP5020HS-1R5M-LF	1.5	6.7	6.9	13.5	16
		SEP5020HS-2R2M-LF	2.2	6	5.8	19	23
		SEP5020HS-3R3M-LF	3.3	5	5	25	30
		SEP5020HS-4R7M-LF	4.7	4	4.5	30	36
		SEP5020HS-6R8M-LF	6.8	3.4	3.6	50	60
		SEP5020HS-100M-LF	10	2.7	3	70	84
		SEP5020HS-220M-LF	22	2.3	2	150	180
		SEP5020HS-330M-LF	33	2.1	1.6	230	270
		SEP5020HS-470M-LF	47	1.4	1.4	300	360
		SEP5020HS-680M-LF	68	1.2	1.1	470	560

PART NUMBERING SYSTEM

SEP	5020HS	—	1R5M	—	LF
TYPE	DIMENSIONS		INDUCTANCE		LEAD FREE

FEATURES :

- Low profile (2.0mm max. height) and 5.3X5.1 mm max. square.
- Excellent current handling – up to 13.3A; Exceptionally low DCR – only 6.0 mOhms
- Inductance range: 0.47 μH – 68 μH with AEC-Q200 compliant

SHAPES AND DIMENSIONS :

UNIT : mm

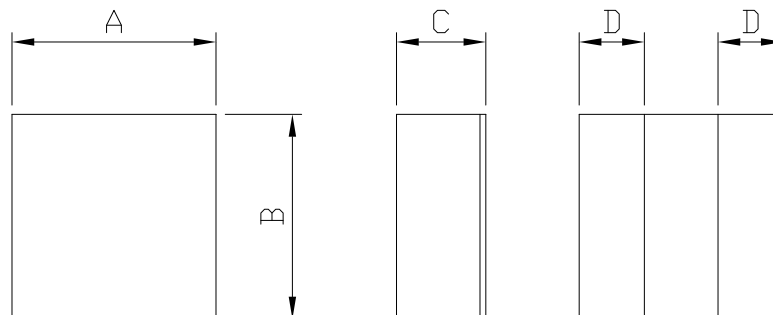

A=5.0 \pm 0.30 B=4.8 \pm 0.30 C=2.00 Max. D=1.5 \pm 0.20

RECOMMENDED PATTERNS

UNIT : mm

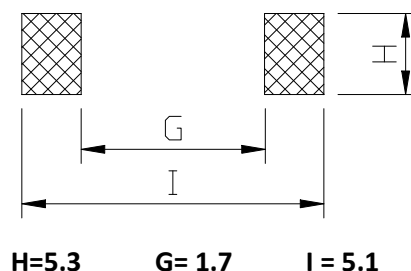

H=5.3 G= 1.7 I = 5.1

SEP5020HS SERIES ~ High Current Power Inductors



SPECIFICATION TABLE

PART NUMBER	INDUCTANCE (μ H)	Isat (A) (Typ.)	Irms (A) (Typ.)	DCR (m Ω) (Typ.)	DCR (m Ω) (Max.)
SEP5020HS-R47M-LF	0.47 \pm 20%	13.3	11.0	6.00	7.20
SEP5020HS-1R0M-LF	1.00 \pm 20%	8.00	7.60	11.5	13.5
SEP5020HS-1R5M-LF	1.50 \pm 20%	6.70	6.90	13.5	16.0
SEP5020HS-2R2M-LF	2.20 \pm 20%	6.00	5.80	19.0	23.0
SEP5020HS-3R3M-LF	3.30 \pm 20%	5.00	5.00	25.0	30.0
SEP5020HS-4R7M-LF	4.70 \pm 20%	4.00	4.50	30.0	36.0
SEP5020HS-6R8M-LF	6.80 \pm 20%	3.40	3.60	50.0	60.0
SEP5020HS-100M-LF	10.0 \pm 20%	2.70	3.00	70.0	84.0
SEP5020HS-220M-LF	22.0 \pm 20%	2.30	2.00	150	180
SEP5020HS-330M-LF	33.0 \pm 20%	2.10	1.60	230	270
SEP5020HS-470M-LF	47.0 \pm 20%	1.40	1.40	300	360
SEP5020HS-680M-LF	68.0 \pm 20%	1.20	1.10	470	560

- Isat : DC current at which the inductance drops 30% (Max) from its value without current.
- Irms : Average current for a 40°C temperature rise above 25°C ambient.
- Test Frequency at 1MHz / 0.1V
- Operating temperature range -40°C to +125°C , Electrical specifications at 25°C.