



SSB5D11 SERIES – Low Profile SMD Power Inductors



RoHS Compliant

PART NUMBERING SYSTEM

| | | | | | |
|------------|-------------|---|-------------|---|-----------|
| SSB | 5D11 | — | 100M | — | LF |
| TYPE | DIMENSIONS | | INDUCTANCE | | LEAD FREE |

SHAPES AND DIMENSIONS

UNIT : mm

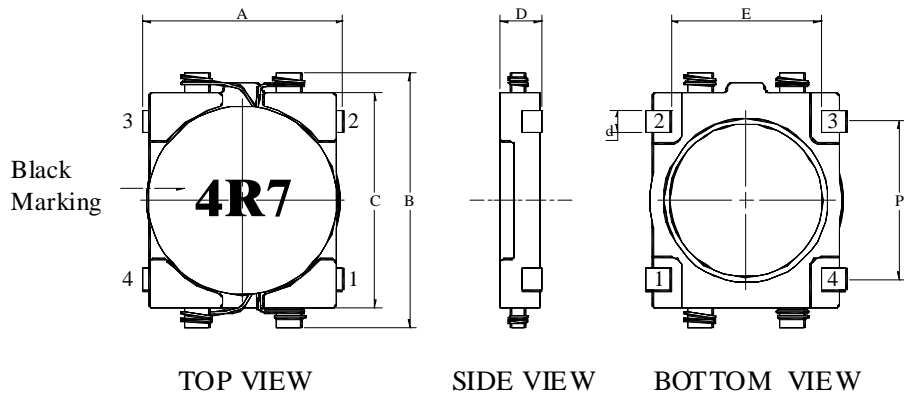

A=5.80 max. B=7.40 max. C=6.0REF D=1.20 max. E=4.2max. P=4.5 REF d=0.60 REF

RECOMMENDED PATTERNS

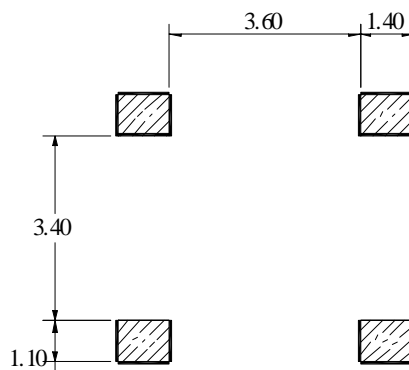

FEATURES

- Low profile (1.20mm max. height) .
- Suitable as inductors for Cellular phone .
- Ideal for a variety of DC-DC converter inductor applications .
- Most suitable for portable electronic equipments requiring low profile and high density mounting .



Coilmaster Electronics Co., Ltd.

9F-3 No.398, Huan Bei Rd. Chung Li City, Taoyuan 320, Taiwan
 Tel : +886-3-422-8279 Fax : +886-3-422-8734

E-mail : info@coilmaster.com.tw

Web Site : www.coilmaster.com.tw

SSB5D11 SERIES – Low Profile SMD Power Inductors



ELECTRICAL CHARACTERISTICS :

| PART NUMBER | INDUCTANCE (μ H) | DCR ($m\Omega$) (max) | IDC (A) (max) | TEST FREQ. (f) |
|-----------------|--------------------------|----------------------------|--------------------|---------------------|
| SSB5D11-3R3M-LF | 3.3 \pm 20% | 109 | 0.94 | 100KHz |
| SSB5D11-4R7M-LF | 4.7 \pm 20% | 156 | 0.80 | 100KHz |
| SSB5D11-6R8M-LF | 6.8 \pm 20% | 216 | 0.65 | 100KHz |
| SSB5D11-100M-LF | 10 \pm 20% | 275 | 0.54 | 100KHz |
| SSB5D11-150M-LF | 15 \pm 20% | 438 | 0.40 | 100KHz |
| SSB5D11-220M-LF | 22 \pm 20% | 663 | 0.36 | 100KHz |
| SSB5D11-330M-LF | 33 \pm 20% | 975 | 0.32 | 100KHz |
| SSB5D11-470M-LF | 47 \pm 20% | 1380 | 0.26 | 100KHz |
| SSB5D11-680M-LF | 68 \pm 20% | 1700 | 0.23 | 100KHz |
| SSB5D11-101M-LF | 100 \pm 20% | 2800 | 0.20 | 100KHz |

1. Operating temperature range : -40 $^{\circ}$ C to + 120 $^{\circ}$ C. Electrical specifications at 25 $^{\circ}$ C.

PACKAGING SPECIFICATION

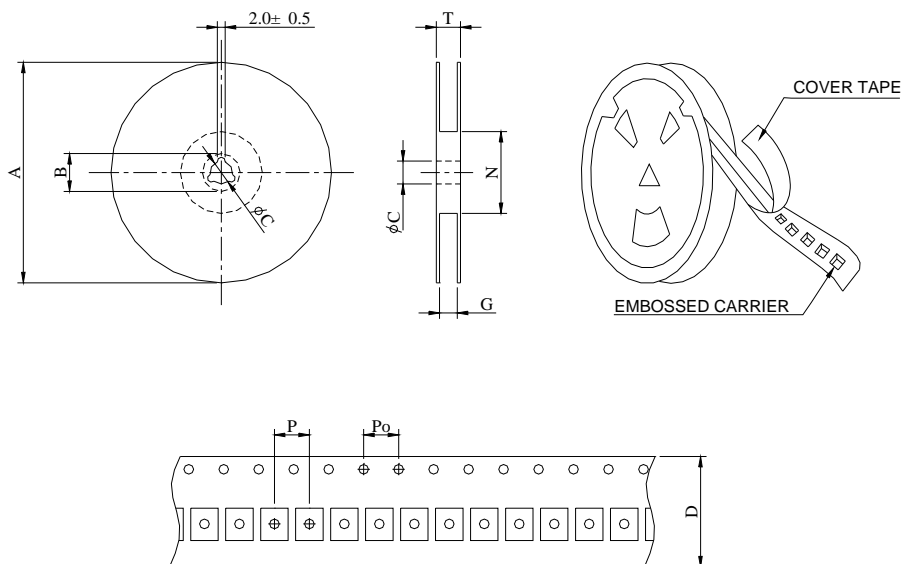

| SERIES | STAYLE | Q' TY (PCS) | DIMENSIONS (m/m) | | | | | | | | |
|---------|--------|----------------|------------------|-------------|-------------|-------------|-----------|-----------|----|-----|------|
| | | | A | B \pm 0.8 | C \pm 0.5 | D \pm 0.3 | G $^{+0}$ | N $^{-0}$ | P | Po | T |
| SSB5D11 | 13 | 1500 | 330 | 21 | 13 | 12 | 12.5 | 100 | 12 | 4.0 | 17.5 |