



SSB5210 SERIES – Low Profile SMD Power Inductors



RoHS Compliant

PART NUMBERING SYSTEM

| | | | | | |
|------------|-------------|---|-------------|---|-----------|
| SSB | 5210 | — | 100M | — | LF |
| TYPE | DIMENSIONS | | INDUCTANCE | | LEAD FREE |

SHAPES AND DIMENSIONS

UNIT : mm

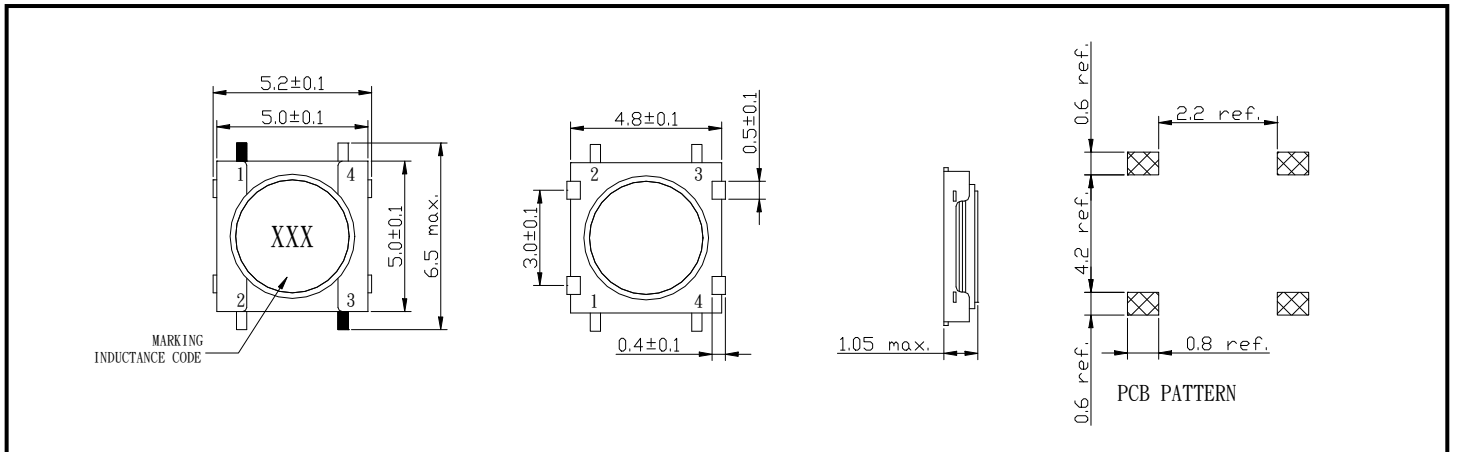

SPECIFICATION TABLE

| PART NUMBER | INDUCTANCE (μ H) | DCR (Ω) (max) | IDC (A) (max) | TEST FREQ. (f) |
|-----------------|--------------------------|---------------------------|------------------|-------------------|
| SSB5210-2R2M-LF | $2.2 \pm 20\%$ | 0.18 | 1.70 | 100KHz |
| SSB5210-3R3M-LF | $3.3 \pm 20\%$ | 0.22 | 1.50 | 100KHz |
| SSB5210-4R7M-LF | $4.7 \pm 20\%$ | 0.28 | 1.32 | 100KHz |
| SSB5210-6R8M-LF | $6.8 \pm 20\%$ | 0.38 | 1.12 | 100KHz |
| SSB5210-100M-LF | $10 \pm 20\%$ | 0.61 | 0.90 | 100KHz |
| SSB5210-150M-LF | $15 \pm 20\%$ | 0.82 | 0.73 | 100KHz |
| SSB5210-220M-LF | $22 \pm 20\%$ | 1.10 | 0.62 | 100KHz |
| SSB5210-330M-LF | $33 \pm 20\%$ | 1.88 | 0.52 | 100KHz |
| SSB5210-470M-LF | $47 \pm 20\%$ | 2.34 | 0.42 | 100KHz |

1. Operating temperature range : -40°C to $+125^{\circ}\text{C}$.
2. Test equivalent : HP4284A LCR meter or equivalent .
3. Electrical specifications at 25°C .



SSB5210 SERIES – Low Profile SMD Power Inductors



RoHS Compliant

PACKAGING SPECIFICATION

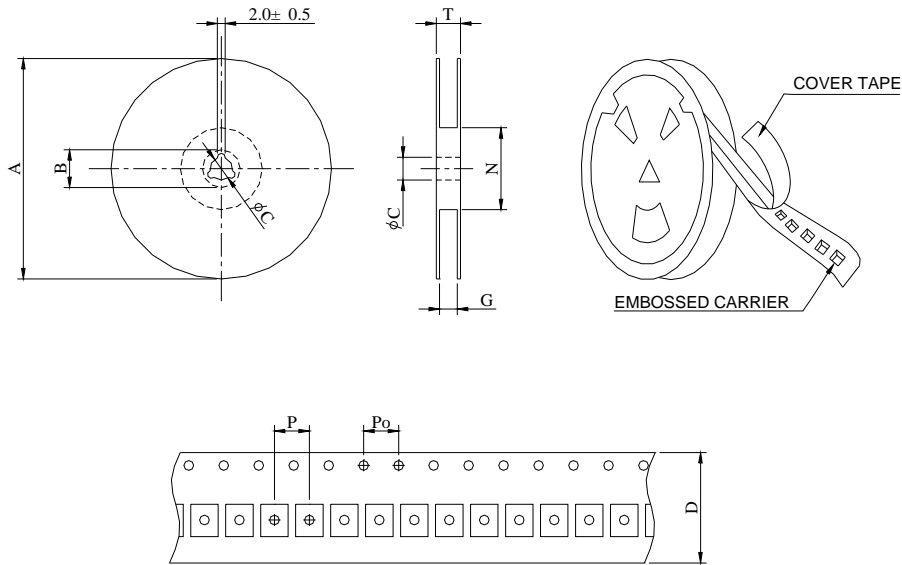

| SERIES | STAYLE | Q' TY (PCS) | DIMENSIONS (m/m) | | | | | | | | |
|---------|--------|----------------|------------------|-------|-------|----|-----------------|-----------------|---|----|------|
| | | | A | B±0.8 | C±0.5 | D | G ⁺⁰ | N ⁻⁰ | P | Po | T |
| SSB5210 | 13-16 | 3000 | 330 | 21 | 13 | 16 | 18 | 50 | 8 | 4 | 22.4 |