



SQH43 SERIES ~ Low Profile SMD Power Inductors



PART NUMBERING SYSTEM

| | | | | | |
|------------|------------|---|-------------|---|-----------|
| SQH | 43 | — | 680K | — | LF |
| TYPE | DIMENSIONS | | INDUCTANCE | | LEAD FREE |

SHAPES AND DIMENSIONS

UNIT : mm

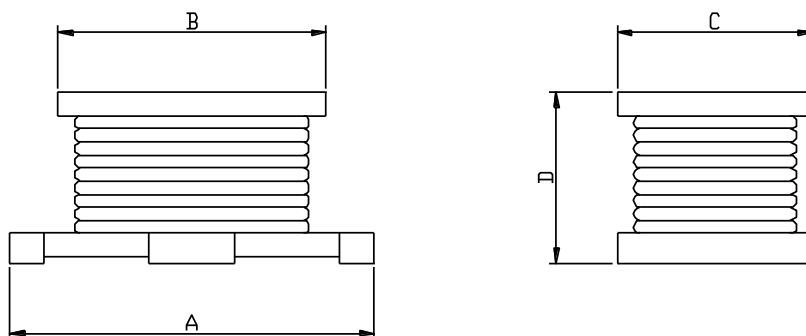

A=4.8 Max. B=3.8 Max. D=3.4 Max D=3.0 Max

RECOMMENDED PATTERNS

UNIT : mm

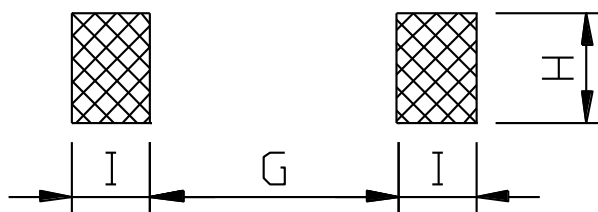

G=1.6 Min. H=3.2 Ref. I=1.2 Min

SQH43 SERIES ~ Low Profile SMD Power Inductors



SPECIFICATION TABLE

| PART NUMBER | INDUCTANCE (μ H) | DCR (Ω) (Max.) | Isat (mA) (Max.) | SRF typ. (HZ) | Test Freq. (Hz) |
|---------------|--------------------------|----------------------------|---------------------|--------------------|-------------------|
| SQH43-1R0M-LF | 1.0 \pm 20% | 0.20 | 500 | 120 | 1MHz |
| SQH43-1R5M-LF | 1.5 \pm 20% | 0.30 | 500 | 85 | 1MHz |
| SQH43-2R2M-LF | 2.2 \pm 20% | 0.30 | 500 | 62 | 1MHz |
| SQH43-3R3M-LF | 3.3 \pm 20% | 0.35 | 500 | 47 | 1MHz |
| SQH43-4R7M-LF | 4.7 \pm 20% | 0.40 | 500 | 38 | 1MHz |
| SQH43-6R8M-LF | 6.8 \pm 20% | 0.50 | 450 | 31 | 1MHz |
| SQH43-100K-LF | 10 \pm 10% | 0.56 | 400 | 23 | 1MHz |
| SQH43-150K-LF | 15 \pm 10% | 0.73 | 360 | 19 | 1MHz |
| SQH43-220K-LF | 22 \pm 10% | 0.94 | 320 | 15 | 1MHz |
| SQH43-330K-LF | 33 \pm 10% | 1.20 | 270 | 12 | 1MHz |
| SQH43-470K-LF | 47 \pm 10% | 1.50 | 220 | 10 | 1MHz |
| SQH43-680K-LF | 68 \pm 10% | 1.90 | 180 | 8.4 | 1MHz |
| SQH43-101K-LF | 100 \pm 10% | 2.50 | 160 | 6.8 | 1MHz |
| SQH43-151K-LF | 150 \pm 10% | 3.70 | 130 | 5.5 | 1MHz |
| SQH43-221K-LF | 220 \pm 10% | 5.40 | 115 | 4.5 | 1MHz |
| SQH43-331K-LF | 330 \pm 10% | 8.20 | 95 | 3.6 | 1MHz |
| SQH43-471K-LF | 470 \pm 10% | 11.8 | 80 | 3.0 | 1KHz |
| SQH43-681K-LF | 680 \pm 10% | 17.0 | 65 | 2.5 | 1KHz |
| SQH43-102K-LF | 1000 \pm 10% | 25.0 | 50 | 2.0 | 1KHz |
| SQH43-122K-LF | 1200 \pm 10% | 30.0 | 45 | 1.8 | 1KHz |
| SQH43-152K-LF | 1500 \pm 10% | 37.0 | 40 | 1.6 | 1KHz |
| SQH43-182K-LF | 1800 \pm 10% | 45.0 | 35 | 1.5 | 1KHz |
| SQH43-222K-LF | 2200 \pm 10% | 50.0 | 30 | 1.3 | 1KHz |

- Inductance using an Agilent/HP 4263B LCR meter or equivalent.
- Isat: For inductance values $\geq 10 \mu$ H, DC current at which the inductance drops 10% (max) from its value without current. For inductance values $< 10 \mu$ H, DC current at which the inductance drops 20% (max) from its value without current.
- Irms: Current that causes specified temperature rise from 25°C ambient.
- Operating temperature range -40°C to +125°C ,
- Electrical specifications at 20°C .