



## SPS1008 SERIES ~ Shielded Power Inductors



### PART NUMBERING SYSTEM

<b>SPS</b>	<b>1008</b>	—	<b>2R2M</b>	—	<b>LF</b>
TYPE	DIMENSIONS		INDUCTANCE		LEAD FREE

### SHAPES AND DIMENSIONS

UNIT : mm

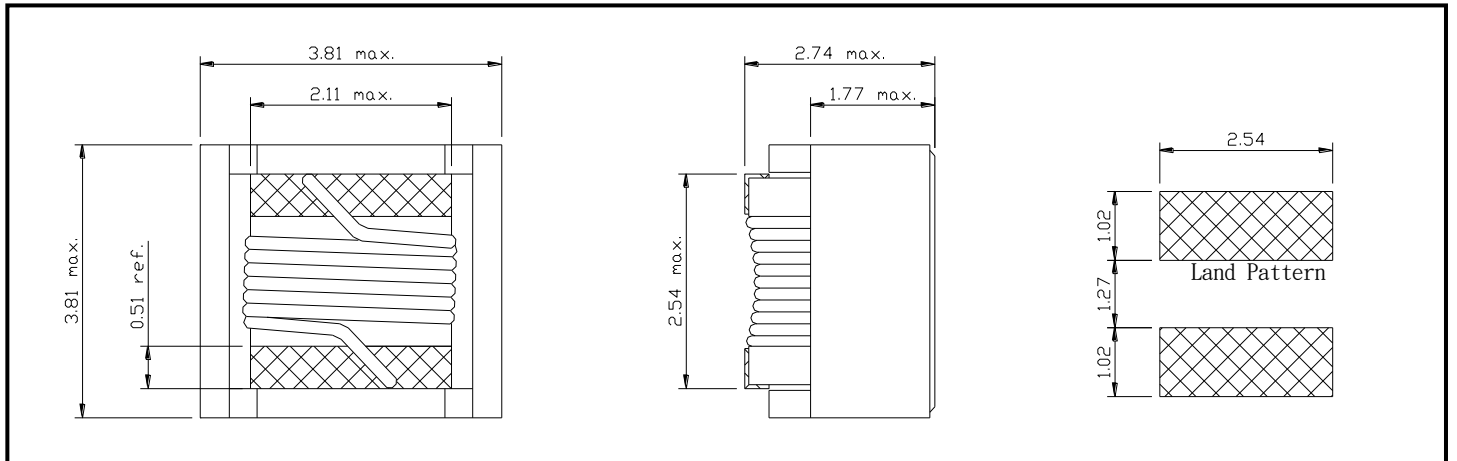



## SPS1008 SERIES ~ Shielded Power Inductors



### SPECIFICATION TABLE

PART NUMBER	INDUCTANCE ( $\mu$ H)	Testing Frequency	Q. Min.	DCR ( $\Omega$ ) (Max.)	SRF (MHz) Typ.	Isat (A)	Irms (A)
SPS1008-1R0M-LF	1.0 $\pm$ 20%	100KHz	26@1MHz	0.05	344	3.00	2.00
SPS1008-1R5M-LF	1.5 $\pm$ 20%	100KHz	26@1MHz	0.06	260	2.80	2.00
SPS1008-1R8M-LF	1.8 $\pm$ 20%	100KHz	28@1MHz	0.09	225	2.10	1.90
SPS1008-2R7M-LF	2.2 $\pm$ 20%	100KHz	30@1MHz	0.14	228	1.50	1.60
SPS1008-2R7M-LF	2.7 $\pm$ 20%	100KHz	30@1MHz	0.14	185	1.50	1.60
SPS1008-3R9M-LF	3.9 $\pm$ 20%	100KHz	30@1MHz	0.26	172	1.20	1.20
SPS1008-4R7M-LF	4.7 $\pm$ 20%	100KHz	30@1MHz	0.35	157	1.10	1.10
SPS1008-5R6M-LF	5.6 $\pm$ 20%	100KHz	30@1MHz	0.36	150	1.10	0.90
SPS1008-6R8M-LF	6.8 $\pm$ 20%	100KHz	30@1MHz	0.58	110	0.90	0.80
SPS1008-100M-LF	10 $\pm$ 20%	100KHz	30@1MHz	0.92	95	0.82	0.72
SPS1008-150M-LF	15 $\pm$ 20%	100KHz	30@1MHz	1.15	75	0.70	0.60
SPS1008-220M-LF	22 $\pm$ 20%	100KHz	33@1MHz	1.40	30	0.65	0.55
SPS1008-330M-LF	33 $\pm$ 20%	100KHz	33@1MHz	1.61	21	0.52	0.20
SPS1008-390M-LF	39 $\pm$ 20%	100KHz	33@1MHz	1.85	18	0.46	0.47
SPS1008-470M-LF	47 $\pm$ 20%	100KHz	33@1MHz	2.5	15	0.43	0.42
SPS1008-680M-LF	68 $\pm$ 20%	100KHz	33@1MHz	3.8	12	0.33	0.32
SPS1008-820M-LF	82 $\pm$ 20%	100KHz	33@1MHz	4.3	10	0.32	0.30
SPS1008-101M-LF	100 $\pm$ 20%	100KHz	33@1MHz	5.8	8.0	0.31	0.30
SPS1008-121M-LF	120 $\pm$ 20%	100KHz	33@1MHz	6.3	8.0	0.25	0.28
SPS1008-151M-LF	150 $\pm$ 20%	100KHz	33@1MHz	7.5	5.8	0.24	0.26
SPS1008-221M-LF	220 $\pm$ 20%	100KHz	33@1MHz	10.0	5.5	0.22	0.21
SPS1008-331M-LF	330 $\pm$ 20%	100KHz	33@1MHz	11.5	3.8	0.20	0.19
SPS1008-471M-LF	470 $\pm$ 20%	100KHz	33@1MHz	16.3	3.1	0.16	0.18
SPS1008-561M-LF	560 $\pm$ 20%	100KHz	33@1MHz	18.1	2.8	0.13	0.15
SPS1008-681M-LF	680 $\pm$ 20%	100KHz	33@1MHz	24.0	2.5	0.12	0.14
SPS1008-821M-LF	820 $\pm$ 20%	100KHz	23@1MHz	26.0	2.0	0.10	0.12
SPS1008-102M-LF	1000 $\pm$ 20%	100KHz	20@1MHz	29.0	1.5	0.10	0.11

- Isat: DC current at which the inductance drops 10% (typ) from its value without current.
- Irms: Average current for 40°C temperature rise from 25°C ambient .
- Operating temperature range -40°C to +105°C.
- Electrical specifications at 25°C.