

## SDS65P SERIES ~ Shielded SMD Power Inductors



### PART NUMBERING SYSTEM

<b>SDS</b>	<b>65P</b>	—	<b>101M</b>	—	<b>LF</b>
TYPE	DIMENSIONS		INDUCTANCE		LEAD FREE

### SHAPES AND DIMENSIONS

UNIT : mm

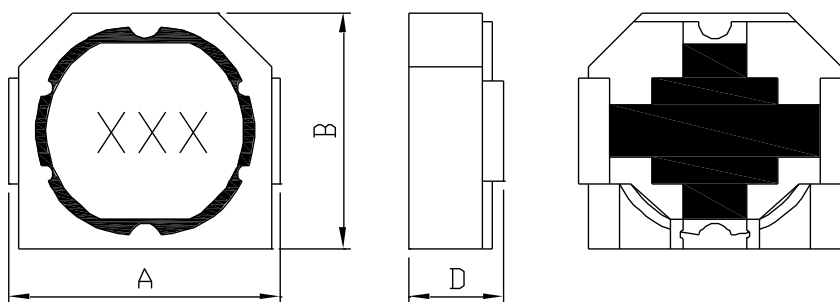

**A= 6.90 Max. B= 6.50 Max. C= 5.00 Max.**

### PACKAGING SPECIFICATION

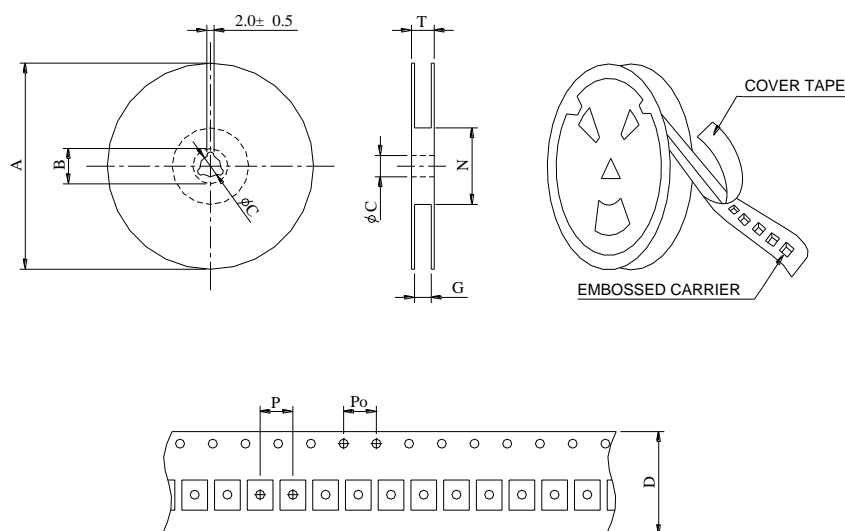

SERIES	STAYLE	Q'TY (PCS)	DIMENSIONS (m/m)								
			A	B±0.8	C±0.5	D	G <sup>+0</sup>	N <sup>0</sup>	P	Po	T
SDS65P	13-16	1000	330	21	13	16	18	50	8	4	22.4



## SDS65P SERIES ~ Shielded SMD Power Inductors



### SPECIFICATION TABLE

PART NUMBER	INDUCTANCE ( $\mu$ H)	DCR (m $\Omega$ ) (Max.)	IDC (A) (Max.)	Marking
SDS65P-100M-LF	10 $\pm$ 20%	75.6	1.80	100
SDS65P-120M-LF	12 $\pm$ 20%	85.2	1.70	120
SDS65P-150M-LF	15 $\pm$ 20%	94.8	1.60	150
SDS65P-180M-LF	18 $\pm$ 20%	105.6	1.40	180
SDS65P-220M-LF	22 $\pm$ 20%	117.6	1.30	220
SDS65P-270M-LF	27 $\pm$ 20%	132.0	1.20	270
SDS65P-330M-LF	33 $\pm$ 20%	156.0	1.10	330
SDS65P-390M-LF	39 $\pm$ 20%	180.0	1.00	390
SDS65P-470M-LF	47 $\pm$ 20%	192.0	0.90	470
SDS65P-560M-LF	56 $\pm$ 20%	252.0	0.80	560
SDS65P-680M-LF	68 $\pm$ 20%	276.0	0.70	680
SDS65P-820M-LF	82 $\pm$ 20%	312.0	0.65	820
SDS65P-101M-LF	100 $\pm$ 20%	432.0	0.60	101
SDS65P-121M-LF	120 $\pm$ 20%	576.0	0.58	121
SDS65P-151M-LF	150 $\pm$ 20%	816.0	0.50	151
SDS65P-181M-LF	180 $\pm$ 20%	900.0	0.47	181
SDS65P-221M-LF	220 $\pm$ 20%	1008	0.41	221
SDS65P-271M-LF	270 $\pm$ 20%	1440	0.37	271
SDS65P-331M-LF	330 $\pm$ 20%	1632	0.33	331
SDS65P-391M-LF	390 $\pm$ 20%	1800	0.30	391
SDS65P-471M-LF	470 $\pm$ 20%	2016	0.27	471
SDS65P-561M-LF	560 $\pm$ 20%	3036	0.26	561
SDS65P-681M-LF	680 $\pm$ 20%	3396	0.24	681
SDS65P-821M-LF	820 $\pm$ 20%	3768	0.20	821
SDS65P-102M-LF	1000 $\pm$ 20%	4404	0.18	102

- Test Frequency : 100KHz 0.1Vrms .
- DC current at which the inductance drops 20% (typ) from its value without current.
- Operating temperature range -40 $^{\circ}$ C to +125 $^{\circ}$ C ,
- Electrical specifications at 20 $^{\circ}$ C .