



SDS63P SERIES ~ Shielded SMD Power Inductors



PART NUMBERING SYSTEM

SDS	63P	—	330M	—	LF
TYPE	DIMENSIONS		INDUCTANCE		LEAD FREE

SHAPES AND DIMENSIONS

UNIT : mm

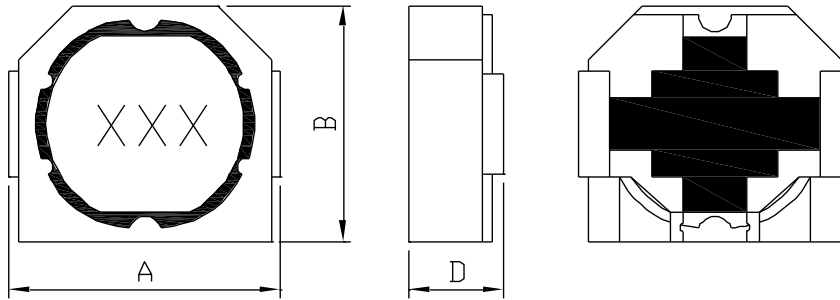

A= 6.50 Max. B= 6.90 Max. C= 3.30 Max.

PACKAGING SPECIFICATION

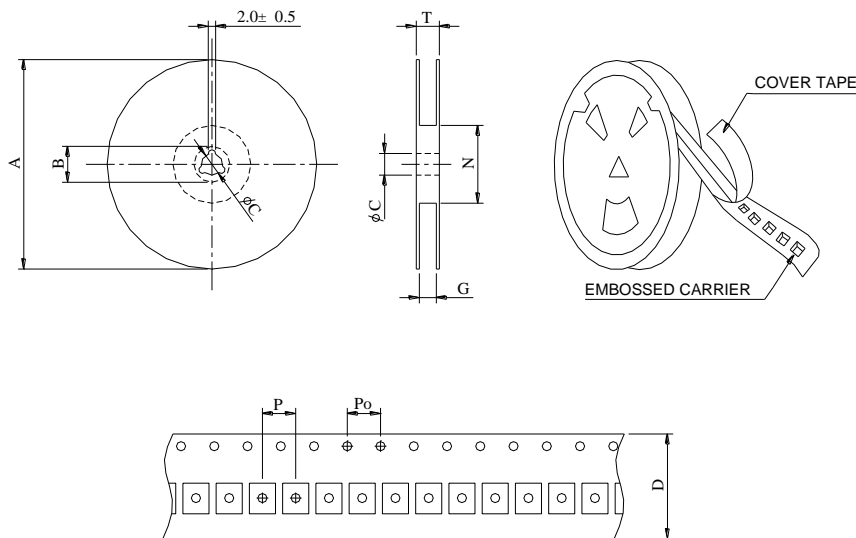

SERIES	STAYLE	Q'TY (PCS)	DIMENSIONS (m/m)								
			A	B±0.8	C±0.5	D	G ⁺⁰	N ⁰	P	Po	T
SDS63P	13-16	1000	330	21	13	16	18	50	8	4	22.4

SDS63P SERIES ~ Shielded SMD Power Inductors



SPECIFICATION TABLE

PART NUMBER	INDUCTANCE (μ H)	DCR (m Ω) (Max.)	IDC (A) (Max.)	Marking
SDS63P-1R0M-LF	1.0 \pm 20%	22.8	3.40	1R0
SDS63P-1R5M-LF	1.5 \pm 20%	28.8	3.20	1R5
SDS63P-2R7M-LF	2.7 \pm 20%	37.2	2.40	2R7
SDS63P-3R3M-LF	3.3 \pm 20%	40.8	2.20	3R3
SDS63P-4R7M-LF	4.7 \pm 20%	50.4	2.00	4R7
SDS63P-5R6M-LF	5.6 \pm 20%	58.8	1.80	5R6
SDS63P-6R8M-LF	6.8 \pm 20%	62.4	1.50	6R8
SDS63P-8R2M-LF	8.2 \pm 20%	73.2	1.40	8R2
SDS63P-100M-LF	10 \pm 20%	78.0	1.30	100
SDS63P-120M-LF	12 \pm 20%	85.6	1.20	120
SDS63P-150M-LF	15 \pm 20%	115.2	1.10	150
SDS63P-180M-LF	18 \pm 20%	132.0	1.00	180
SDS63P-220M-LF	22 \pm 20%	168.0	0.90	220
SDS63P-270M-LF	27 \pm 20%	192.0	0.80	270
SDS63P-330M-LF	33 \pm 20%	216.0	0.70	330
SDS63P-390M-LF	39 \pm 20%	288.0	0.65	390
SDS63P-470M-LF	47 \pm 20%	324.0	0.60	470
SDS63P-560M-LF	56 \pm 20%	348.0	0.55	560
SDS63P-680M-LF	68 \pm 20%	624.0	0.50	680
SDS63P-820M-LF	82 \pm 20%	720.0	0.45	820
SDS63P-101M-LF	100 \pm 20%	816.0	0.40	101
SDS63P-121M-LF	120 \pm 20%	900.0	0.37	121
SDS63P-151M-LF	150 \pm 20%	1032.0	0.35	151
SDS63P-181M-LF	180 \pm 20%	1440.0	0.30	181

- Test Frequency : 100KHz 0.1Vrms .
- DC current at which the inductance drops 20% (typ) from its value without current.
- Operating temperature range -40 $^{\circ}$ C to +125 $^{\circ}$ C ,
- Electrical specifications at 20 $^{\circ}$ C .