

SDS5020D SERIES ~ Shielded SMD Power Inductors



PART NUMBERING SYSTEM

SDS	5020D	—	4R7M	—	LF
TYPE	DIMENSIONS		INDUCTANCE		LEAD FREE

SHAPES AND DIMENSIONS

UNIT : mm

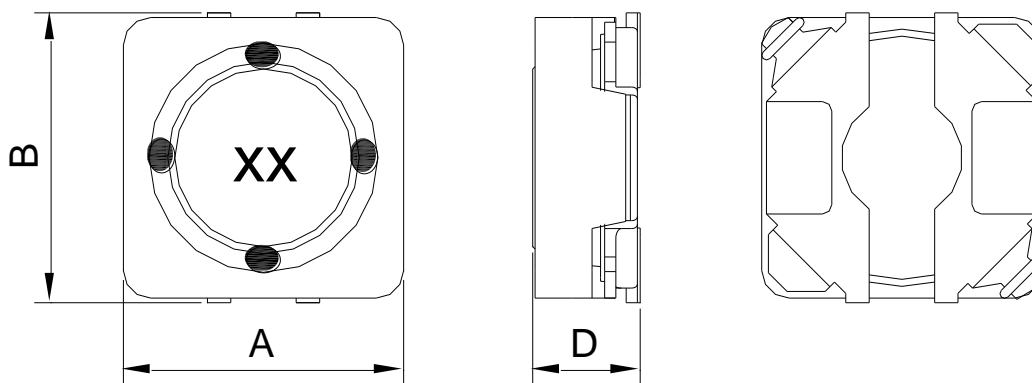

A=5.2 Max. B=5.3 Max. D=2.0 Max.

RECOMMENDED PATTERNS

UNIT : mm

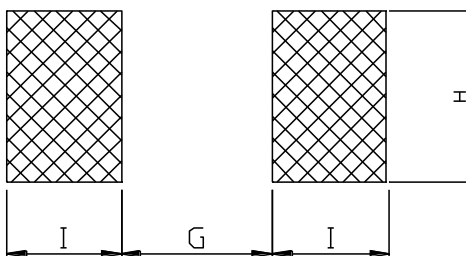

G=1.4 H=5.4 I=2.0



SDS5020D SERIES ~ Shielded SMD Power Inductors



ELECTRICAL CHARACTERISTICS :

PART NUMBER	INDUCTANCE (μ H)	DCR (Ω) Max.(Typ.)	Isat (A) (Max.)	Irms (A) (Max.)	Stamp
SDS5020D-1R0N-LF	1.0 \pm 30%	51.6m(43m)	3.80	2.60	4A
SDS5020D-2R7N-LF	2.7 \pm 30%	90.0m(75m)	2.10	2.00	4F
SDS5020D-4R7M-LF	4.7 \pm 20%	0.120(0.10)	1.80	1.70	4I
SDS5020D-220M-LF	22 \pm 20%	0.276(0.23)	0.75	1.25	4Q
SDS5020D-470M-LF	47 \pm 20%	0.480(0.40)	0.55	0.75	4U

- Inductance tested at 100 kHz, 0.1 Vrms, 0 Adc using an Agilent/HP 4284B LCR meter or equivalent.
- Isat : DC current at which the inductance drops 30% (typ) from its value without current.
- Irms: The actual current when temperature of coil becomes $\Delta 40^{\circ}\text{C}$. (Ta= $+25^{\circ}\text{C}$)
Operating temperature range -40°C to $+125^{\circ}\text{C}$, Electrical specifications at 25°C .