



SDS5015D SERIES ~ Shielded SMD Power Inductors



PART NUMBERING SYSTEM

SDS	5015D	—	4R7M	—	LF
TYPE	DIMENSIONS		INDUCTANCE		LEAD FREE

SHAPES AND DIMENSIONS

UNIT : mm

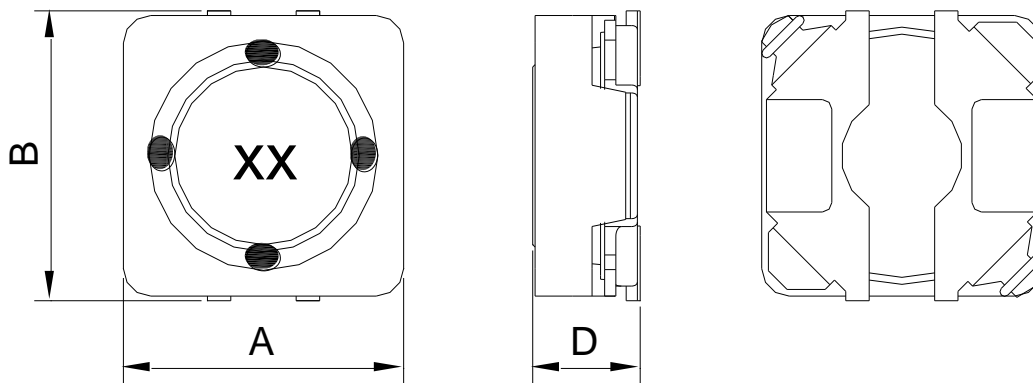

A=5.2 Max. B=5.3 Max. D=1.5 Max.

RECOMMENDED PATTERNS

UNIT : mm

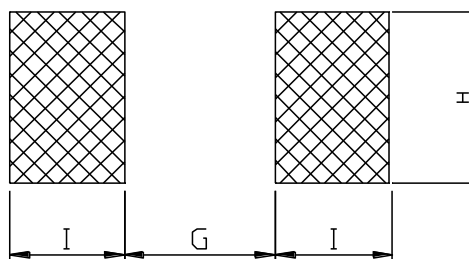

G=1.4 H=5.4 I=2.0

SDS5015D SERIES ~ Shielded SMD Power Inductors



ELECTRICAL CHARACTERISTICS :

PART NUMBER	INDUCTANCE (μ H)	DCR (Ω) Max.(Typ.)	Isat (A) (Max.)	Irms (A) (Max.)	Stamp
SDS5015D-2R7N-LF	2.7 \pm 30%	80.4m(67m)	1.70	2.00	4F
SDS5015D-3R3N-LF	3.3 \pm 30%	91.2m(76m)	1.50	1.80	4G
SDS5015D-4R7M-LF	4.7 \pm 20%	0.115(96m)	1.20	1.60	4I
SDS5015D-6R8M-LF	6.8 \pm 20%	0.132(0.11)	1.00	1.50	4K

- Inductance tested at 100 kHz, 0.1 Vrms, 0 Adc using an Agilent/HP 4284B LCR meter or equivalent.
- Isat : DC current at which the inductance drops 30% (typ) from its value without current.
- Irms: The actual current when temperature of coil becomes $\Delta 40^{\circ}\text{C}$. (Ta=+25 $^{\circ}\text{C}$)
 Operating temperature range -40 $^{\circ}\text{C}$ to +125 $^{\circ}\text{C}$, Electrical specifications at 25 $^{\circ}\text{C}$.