



SDS4018D SERIES ~ Shielded SMD Power Inductors



PART NUMBERING SYSTEM

SDS	4018D	—	4R7M	—	LF
TYPE	DIMENSIONS		INDUCTANCE		LEAD FREE

SHAPES AND DIMENSIONS

UNIT : mm

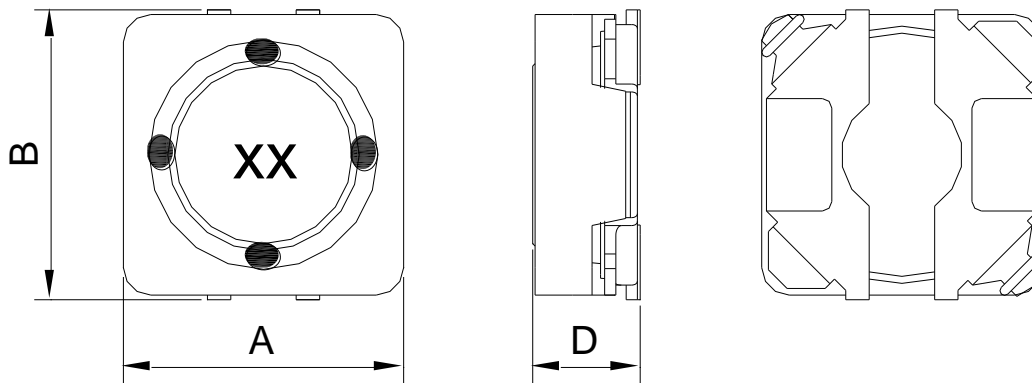

A=4.2 Max. B=4.5 Max. D=1.8 Max.

RECOMMENDED PATTERNS

UNIT : mm

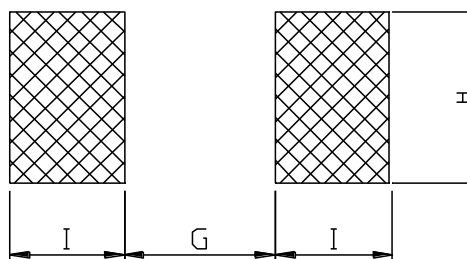

G=1.0 H=4.3 I=1.6

SDS4018D SERIES ~ Shielded SMD Power Inductors



ELECTRICAL CHARACTERISTICS :

PART NUMBER	INDUCTANCE (μ H)	DCR (Ω) Max.(Typ.)	Isat (A) (Max.)	Irms (A) (Max.)	SRF (MHz) (Typ.)	Stamp
SDS4018D-1R0N-LF	1.0 \pm 30%	51.6m(41m)	2.70	2.40	180	3A
SDS4018D-1R2N-LF	1.2 \pm 30%	60.0m(46m)	2.30	2.20	160	3B
SDS4018D-1R5N-LF	1.5 \pm 30%	68.4m(51m)	2.10	2.00	140	3C
SDS4018D-1R8N-LF	1.8 \pm 30%	96.0m(59m)	1.90	1.85	115	3D
SDS4018D-2R2N-LF	2.2 \pm 30%	96.0m(59m)	1.90	1.85	90	3E
SDS4018D-3R3N-LF	3.3 \pm 30%	0.119(74m)	1.40	1.60	75	3G
SDS4018D-3R9N-LF	3.9 \pm 30%	0.156(82m)	1.30	1.50	69	3H
SDS4018D-4R7M-LF	4.7 \pm 20%	0.228(99m)	1.20	1.35	65	3O
SDS4018D-5R6M-LF	5.6 \pm 20%	0.336(0.11)	1.10	1.25	57	3Q
SDS4018D-6R8M-LF	6.8 \pm 20%	0.408(0.13)	1.00	1.20	50	3S
SDS4018D-8R2M-LF	8.2 \pm 20%	0.636(0.14)	0.90	1.10	44	3U
SDS4018D-100M-LF	10 \pm 20%	0.900(0.15)	0.85	1.00	40	3M
SDS4018D-120M-LF	12 \pm 20%	0.228(0.22)	0.80	0.95	35	3O
SDS4018D-150M-LF	15 \pm 20%	0.336(0.24)	0.70	0.90	32	3Q
SDS4018D-180M-LF	18 \pm 20%	0.408(0.26)	0.65	0.85	27	3S
SDS4018D-220M-LF	22 \pm 20%	0.636(0.37)	0.55	0.75	26	3U
SDS4018D-270M-LF	27 \pm 20%	0.900(0.42)	0.50	0.70	23	3M
SDS4018D-330M-LF	33 \pm 20%	0.228(0.48)	0.45	0.60	20	3M
SDS4018D-470M-LF	47 \pm 20%	0.228(0.62)	0.40	0.50	16	3O

- Inductance tested at 100 kHz, 0.1 Vrms, 0 Adc using an Agilent/HP 4284B LCR meter or equivalent.
- Isat : DC current at which the inductance drops 30% (typ) from its value without current.
- Irms: The actual current when temperature of coil becomes $\Delta 40^{\circ}\text{C}$. ($T_a = +25^{\circ}\text{C}$)
 Operating temperature range -40°C to $+125^{\circ}\text{C}$, Electrical specifications at 25°C .