



SDS4015D SERIES ~ Shielded SMD Power Inductors



PART NUMBERING SYSTEM

SDS	4015D	—	6R8M	—	LF
TYPE	DIMENSIONS		INDUCTANCE		LEAD FREE

SHAPES AND DIMENSIONS

UNIT : mm

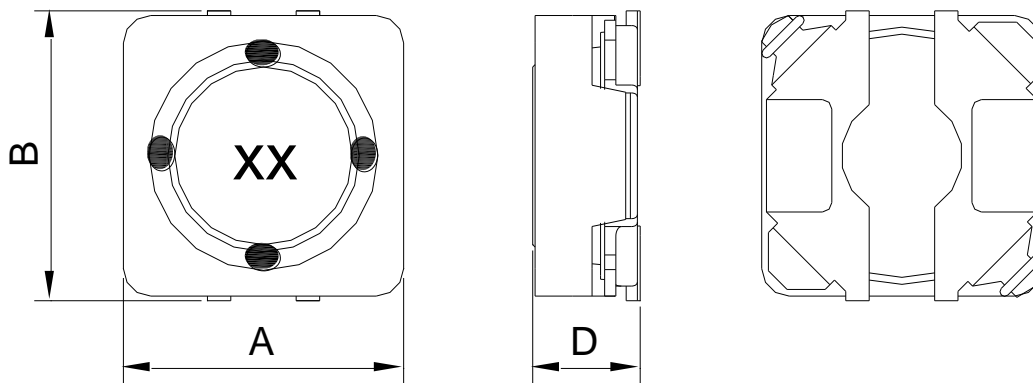

A=4.2 Max. B=4.3 Max. D=1.5 Max.

RECOMMENDED PATTERNS

UNIT : mm

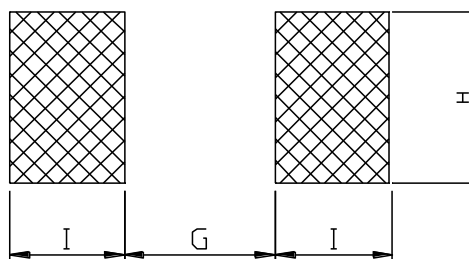

G=1.0 H=4.3 I=1.6

SDS4015D SERIES ~ Shielded SMD Power Inductors



ELECTRICAL CHARACTERISTICS :

PART NUMBER	INDUCTANCE (μ H)	DCR (Ω) Max.(Typ.)	Isat (A) (Max.)	Irms (A) (Max.)	Stamp
SDS4015D-1R0N-LF	1.2 \pm 30%	51.6m(43m)	2.30	2.30	3A
SDS4015D-1R5N-LF	1.5 \pm 30%	60.0m(50m)	2.00	2.05	3C
SDS4015D-2R2N-LF	2.2 \pm 30%	68.4m(57m)	1.70	1.85	3E
SDS4015D-3R3N-LF	3.3 \pm 30%	96.0m(80m)	1.30	1.60	3G
SDS4015D-4R7M-LF	4.7 \pm 20%	0.119(99m)	1.10	1.25	3I
SDS4015D-6R8M-LF	6.8 \pm 20%	0.156(0.13)	1.00	1.15	3K
SDS4015D-100M-LF	10 \pm 20%	0.228(0.19)	0.78	1.00	3M
SDS4015D-150M-LF	15 \pm 20%	0.336(0.28)	0.63	0.88	3O
SDS4015D-220M-LF	22 \pm 20%	0.408(0.34)	0.57	0.80	3Q
SDS4015D-330M-LF	33 \pm 20%	0.636(0.53)	0.44	0.56	3S
SDS4015D-470M-LF	47 \pm 20%	0.900(0.75)	0.35	0.40	3U

- Inductance tested at 100 kHz, 0.1 Vrms, 0 Adc using an Agilent/HP 4284B LCR meter or equivalent.
- Isat : DC current at which the inductance drops 30% (typ) from its value without current.
- Irms: The actual current when temperature of coil becomes $\Delta 40^{\circ}\text{C}$. ($T_a=+25^{\circ}\text{C}$)
- Operating temperature range -40°C to $+125^{\circ}\text{C}$, Electrical specifications at 25°C .