



SDS4012D SERIES ~ Shielded SMD Power Inductors



PART NUMBERING SYSTEM

SDS	4012D	—	100M	—	LF
TYPE	DIMENSIONS		INDUCTANCE		LEAD FREE

SHAPES AND DIMENSIONS

UNIT : mm

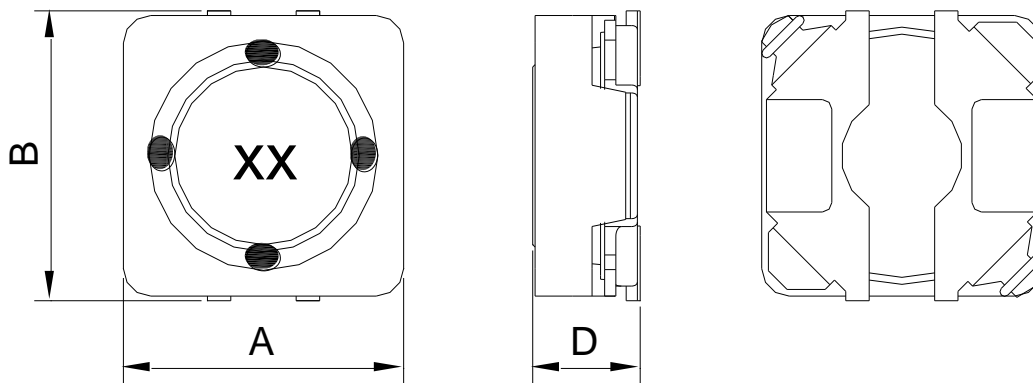

A=4.2 Max. B=4.3 Max. D=1.2 Max.

RECOMMENDED PATTERNS

UNIT : mm

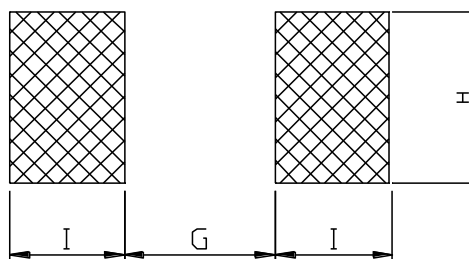

G=1.0 H=4.3 I=1.6

SDS4012D SERIES ~ Shielded SMD Power Inductors



ELECTRICAL CHARACTERISTICS :

PART NUMBER	INDUCTANCE (μ H)	DCR (Ω) Max.(Typ.)	Isat (A) (Max.)	Irms (A) (Max.)	Stamp
SDS4012D-1R2N-LF	1.2 \pm 30%	68.4m(57m)	2.00	2.00	3B
SDS4012D-1R5N-LF	1.5 \pm 30%	80.4m(67m)	1.70	1.80	3C
SDS4012D-2R2N-LF	2.2 \pm 30%	0.101(84m)	1.50	1.55	3E
SDS4012D-3R3N-LF	3.3 \pm 30%	0.120(0.10)	1.30	1.25	3G
SDS4012D-4R7M-LF	4.7 \pm 20%	0.168(0.14)	1.10	1.15	3I
SDS4012D-6R8M-LF	6.8 \pm 20%	0.204(0.17)	1.00	1.05	3K
SDS4012D-8R2M-LF	8.2 \pm 20%	0.252(0.21)	0.90	1.00	3L
SDS4012D-100M-LF	10 \pm 20%	0.312(0.26)	0.75	0.90	3M
SDS4012D-120M-LF	12 \pm 20%	0.360(0.30)	0.66	0.85	3N
SDS4012D-150M-LF	15 \pm 20%	0.468(0.39)	0.70	0.75	3O
SDS4012D-180M-LF	18 \pm 20%	0.540(0.45)	0.60	0.60	3P
SDS4012D-220M-LF	22 \pm 20%	0.780(0.65)	0.57	0.50	3Q
SDS4012D-270M-LF	27 \pm 20%	0.900(0.75)	0.48	0.40	3R
SDS4012D-330M-LF	33 \pm 20%	1.020(0.85)	0.39	0.45	3S

- Inductance tested at 100 kHz, 0.1 Vrms, 0 Adc using an Agilent/HP 4284B LCR meter or equivalent.
- Isat : DC current at which the inductance drops 30% (typ) from its value without current.
- Irms: The actual current when temperature of coil becomes $\Delta 40^{\circ}\text{C}$. (Ta= $+25^{\circ}\text{C}$)
- Operating temperature range -40°C to $+125^{\circ}\text{C}$, Electrical specifications at 25°C .