



SDC6D26 SERIES~ SMD Shielded Power Inductors



PART NUMBERING SYSTEM

SDC	6D26	—	6R8N	—	LF
TYPE	DIMENSIONS		INDUCTANCE		LEAD FREE

SHAPES AND DIMENSIONS

UNIT : mm

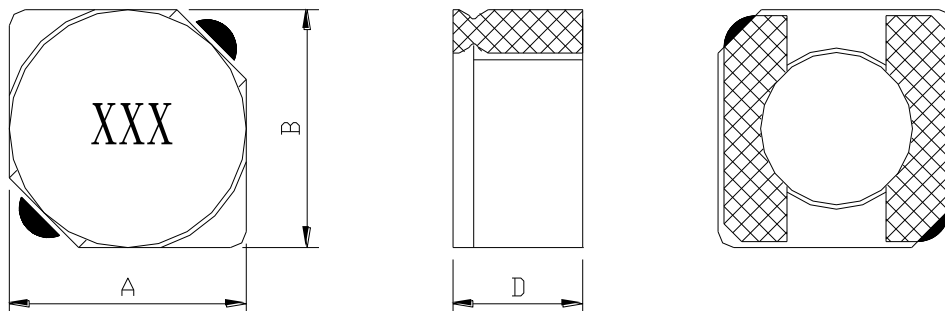

A=7.0 Max. B=7.0 Max. D=2.8 Max.

RECOMMENDED PATTERNS

UNIT : mm

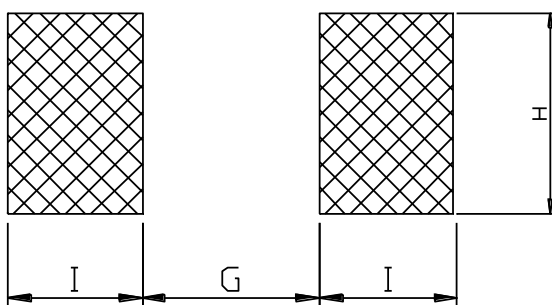

H= 7.3 G= 2.0 I = 2.65



SDC6D26 SERIES~ SMD Shielded Power Inductors



SPECIFICATION TABLE

PART NUMBER	INDUCTANCE (μ H)	DCR (m Ω) (Max.)	IDC (A)	TEST FREQ. (f)
SDC6D26-2R2N-LF	2.2 \pm 30%	22	3.2	10KHz
SDC6D26-2R9N-LF	2.9 \pm 30%	25	2.8	10KHz
SDC6D26-3R6N-LF	3.6 \pm 30%	29	2.5	10KHz
SDC6D26-5R0N-LF	5.0 \pm 30%	32	2.2	10KHz
SDC6D26-5R6N-LF	5.6 \pm 30%	36	2.0	10KHz
SDC6D26-6R8N-LF	6.8 \pm 30%	54	1.8	10KHz
SDC6D26-8R0N-LF	8.0 \pm 30%	60	1.6	10KHz
SDC6D26-100N-LF	10 \pm 30%	71	1.5	10KHz
SDC6D26-120N-LF	12 \pm 30%	78	1.3	10KHz
SDC6D26-150N-LF	15 \pm 30%	106	1.2	10KHz
SDC6D26-180N-LF	18 \pm 30%	114	1.1	10KHz
SDC6D26-220N-LF	22 \pm 30%	129	1.0	10KHz
SDC6D26-270N-LF	27 \pm 30%	185	0.9	10KHz
SDC6D26-330N-LF	33 \pm 30%	203	0.8	10KHz
SDC6D26-390N-LF	39 \pm 30%	223	0.75	10KHz
SDC6D26-470N-LF	47 \pm 30%	300	0.70	10KHz
SDC6D26-560N-LF	56 \pm 30%	340	0.65	10KHz
SDC6D26-680N-LF	68 \pm 30%	347	0.58	10KHz
SDC6D26-820N-LF	82 \pm 30%	490	0.53	10KHz
SDC6D26-101N-LF	100 \pm 30%	560	0.50	10KHz

- Isat : DC current at which the inductance drops 35% (typ) from its value without current.
- Irms: The actual current when temperature of coil becomes $\Delta 40^{\circ}\text{C}$. (Ta=+25 $^{\circ}\text{C}$)
- Operating temperature range -40 $^{\circ}\text{C}$ to +125 $^{\circ}\text{C}$, Electrical specifications at 25 $^{\circ}\text{C}$.
- Packing : 13" reel, machine-ready ,embossed plastic tape (1,000 parts per full reel).



SDC6D26 SERIES

SMD Shielded Power Inductors



RoHS Compliant

PACKAGING SPECIFICATION

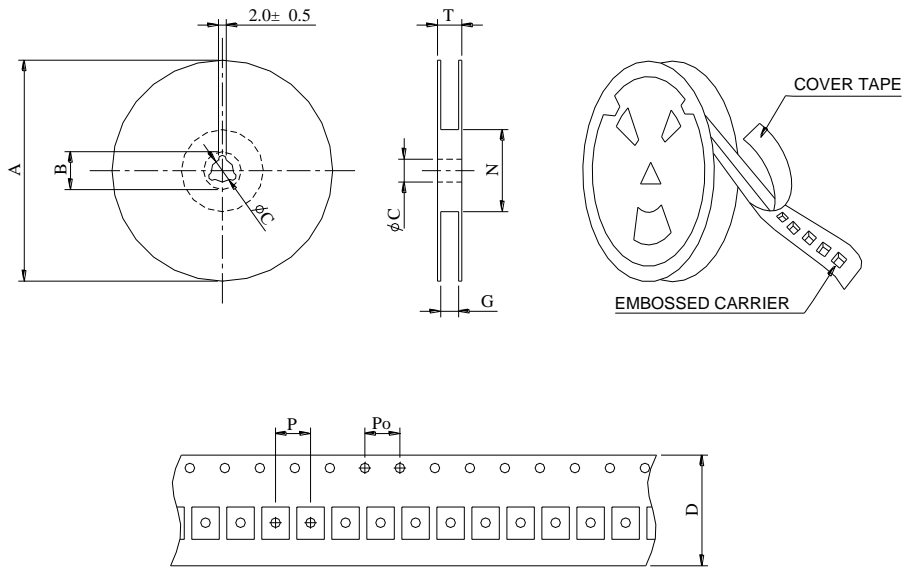

SERIES	STAYLE	Q' TY (PCS)	DIMENSIONS (m/m)								
			A	B±0.8	C±0.5	D	G ⁺⁰	N ⁰	P	Po	T
SDC6D26	13-16	1000	330	21	13	16	18	50	8	4	22.4