



## SDC3D14S SERIES

### Low Profile Shielded Power Inductors



RoHS Compliant

#### PART NUMBERING SYSTEM

<u>SDC</u>	<u>3D14S</u>	—	<u>1R0N</u>	—	<u>LF</u>
TYPE	DIMENSIONS		INDUCTANCE		LEAD FREE

#### SHAPES AND DIMENSIONS

UNIT : mm

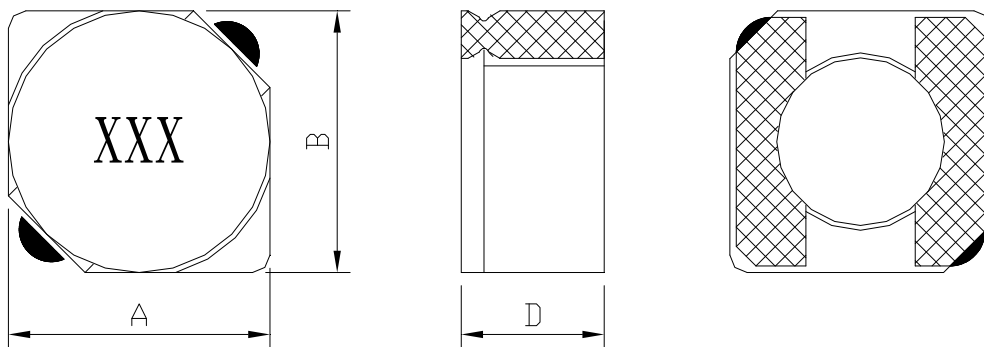

**A=4.0 Max. B=4.0 Max. D=1.55 Max.**

#### PCB LAYOUT

UNIT : mm

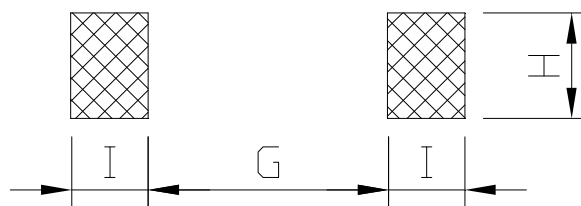

**G=1.30 H=3.90 I=1.30**

#### FEATURES

- Only 4.0 mm square and 1.55 mm high
- Magnetically shielded, low profile power inductor
- Saturation current rating up to 2.55 Amps
- Inductance ratings from 1.0 to 1,500  $\mu$ H
- RoHS-compliant. 260°C compatible. Gold over nickel over phos bronze terminations



**Coilmaster Electronics Co., Ltd.**

9F-3 No.398, Huan Bei Rd. Chung Li City, Taoyuan 320, Taiwan  
Tel : +886-3-422-8279 Fax : +886-3-422-8734

E-mail : [info@coilmaster.com.tw](mailto:info@coilmaster.com.tw)

Web Site : [www.coilmaster.com.tw](http://www.coilmaster.com.tw)

## SDC3D14S SERIES

### Low Profile Shielded Power Inductors



RoHS Compliant

#### ELECTRICAL CHARACTERISTICS :

PART NUMBER	INDUCTANCE ( $\mu$ H)	DCR (m $\Omega$ ) (max)	Isat (A) ( Max. )	Irms (A) ( Max. )	TEST FREQ. ( f )
SDC3D14S-1R0N-LF	1.0 $\pm$ 30%	0.045	2.55	2.10	100KHz
SDC3D14S-2R2N-LF	2.2 $\pm$ 30%	0.100	1.50	1.60	100KHz
SDC3D14S-3R3N-LF	3.3 $\pm$ 30%	0.145	1.30	0.35	100KHz
SDC3D14S-4R7N-LF	4.7 $\pm$ 30%	0.175	1.30	0.25	100KHz
SDC3D14S-4R7N-LF	5.6 $\pm$ 30%	0.220	1.20	1.10	100KHz
SDC3D14S-6R8N-LF	6.8 $\pm$ 30%	0.240	0.86	1.10	100KHz
SDC3D14S-8R2N-LF	8.2 $\pm$ 30%	0.270	0.78	1.00	100KHz
SDC3D14S-100M-LF	10 $\pm$ 20%	0.330	0.70	0.87	100KHz
SDC3D14S-150M-LF	15 $\pm$ 20%	0.440	0.59	0.82	100KHz
SDC3D14S-180M-LF	18 $\pm$ 20%	0.575	0.71	0.68	100KHz
SDC3D14S-220M-LF	22 $\pm$ 20%	0.720	0.49	0.60	100KHz
SDC3D14S-330M-LF	33 $\pm$ 20%	0.920	0.40	0.58	100KHz
SDC3D14S-470M-LF	47 $\pm$ 20%	1.40	0.34	0.47	100KHz
SDC3D14S-560M-LF	56 $\pm$ 20%	1.55	0.31	0.42	100KHz
SDC3D14S-680M-LF	68 $\pm$ 20%	1.80	0.29	0.40	100KHz
SDC3D14S-820M-LF	82 $\pm$ 20%	2.00	0.26	0.39	100KHz
SDC3D14S-101M-LF	100 $\pm$ 20%	2.75	0.24	0.37	100KHz
SDC3D14S-121M-LF	120 $\pm$ 20%	3.45	0.22	0.30	100KHz
SDC3D14S-151M-LF	150 $\pm$ 20%	4.10	0.20	0.27	100KHz
SDC3D14S-181M-LF	180 $\pm$ 20%	4.80	0.18	0.25	100KHz
SDC3D14S-221M-LF	220 $\pm$ 20%	6.00	0.17	0.22	100KHz
SDC3D14S-331M-LF	330 $\pm$ 20%	9.30	0.13	0.18	100KHz
SDC3D14S-471M-LF	470 $\pm$ 20%	12.0	0.11	0.16	100KHz
SDC3D14S-561M-LF	560 $\pm$ 20%	14.0	0.11	0.145	100KHz
SDC3D14S-681M-LF	680 $\pm$ 20%	18.5	0.105	0.125	100KHz
SDC3D14S-821M-LF	820 $\pm$ 20%	24.0	0.100	0.110	100KHz
SDC3D14S-102M-LF	1000 $\pm$ 20%	31.0	0.100	0.100	100KHz
SDC3D14S-152M-LF	1500 $\pm$ 20%	44.0	0.090	0.090	100KHz

- Isat : DC current at which the inductance drops 30% (typ) from its value without current.
- Irms: The actual current when temperature of coil becomes  $\Delta 40^{\circ}\text{C}$  . ( Ta=+25 $^{\circ}\text{C}$  )
- Operating temperature range -40 $^{\circ}\text{C}$  to +125 $^{\circ}\text{C}$  , Electrical specifications at 25 $^{\circ}\text{C}$ .
- Packing : 13" reel, machine-ready ,embossed plastic tape ( 3,500 parts per full reel).