

## SEP4515HS SERIES ~ High Current Power Inductors



### PART NUMBERING SYSTEM

<b>SEP</b>	<b>4515HS</b>	—	<b>2R2M</b>	—	<b>LF</b>
TYPE	DIMENSIONS		INDUCTANCE		LEAD FREE

### FEATURES :

- Low profile ( 1.5mm max. height ) and 4.5X4.3 mm max. square.
- Excellent current handling – up to 8 A; Exceptionally low DCR – only 19.6 mOhms
- Inductance range: 0.47  $\mu$ H – 22  $\mu$ H
- Magnetically shielded and low DC resistance and Suitable for large current .
- Excellent temperature stability for inductance and saturation .

### SHAPES AND DIMENSIONS :

UNIT : mm

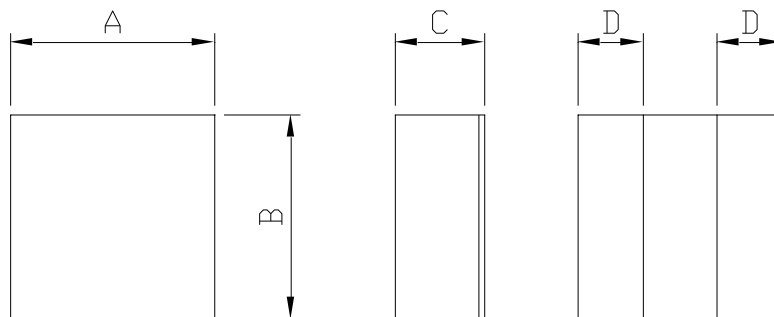

$A=4.5\pm 0.25$     $B=4.3\pm 0.25$     $C=1.50$  Max.    $D=1.3\pm 0.25$

### RECOMMENDED PATTERNS

UNIT : mm

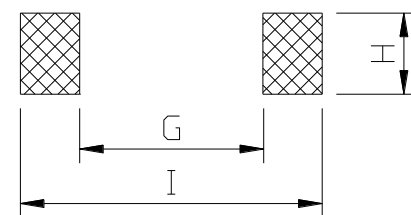

$H=4.7$     $G=1.7$     $I=4.9$



**Coilmaster Electronics Co., Ltd.**  
9F-3 No.398, Huan Bei Rd. Chung Li City, Taoyuan 320, Taiwan

Email: [sales@bec.co.uk](mailto:sales@bec.co.uk)  
Web: [www.bec.co.uk](http://www.bec.co.uk)



## SEP4515HS SERIES ~ High Current Power Inductors



### SPECIFICATION TABLE

PART NUMBER	INDUCTANCE ( $\mu$ H)	I <sub>sat</sub> ( A ) (Typ.)	I <sub>rms</sub> ( A ) (Typ.)	DCR (m $\Omega$ ) (Typ.)	DCR (m $\Omega$ ) (Max.)
SEP4515HS-R47M-LF	0.47 $\pm$ 20%	10.0	7.00	10.0	12.0
SEP4515HS-1R0M-LF	1.00 $\pm$ 20%	5.60	5.00	22.0	26.4
SEP4515HS-2R2M-LF	2.20 $\pm$ 20%	5.20	4.00	38.0	45.0
SEP4515HS-3R3M-LF	3.30 $\pm$ 20%	4.00	3.20	55.0	66.0
SEP4515HS-4R7M-LF	4.70 $\pm$ 20%	3.40	2.70	80.0	96.0
SEP4515HS-6R8M-LF	6.80 $\pm$ 20%	2.80	2.40	100	120
SEP4515HS-100M-LF	10.0 $\pm$ 20%	2.40	1.90	180	180
SEP4515HS-220M-LF	22.0 $\pm$ 20%	1.60	1.30	380	455

- I<sub>sat</sub> : DC current at which the inductance drops 30% (Max) from its value without current.
- I<sub>rms</sub> : Average current for a 40°C temperature rise above 25°C ambient.
- Test Frequency at 1MHz / 0.1V
- Operating temperature range -40°C to +125°C , Electrical specifications at 25°C .