



Coilmaster Electronics Co., Ltd.
9F-3 No.398, Huan Bei Rd. Chung Li City, Taoyuan 320, Taiwan

Email: sales@bec.co.uk
Web: www.bec.co.uk



SEP1207E SERIES~ High Current SMD Power Inductors



PART NUMBERING SYSTEM

SEP	1207E	—	1R5M	—	LF
TYPE	DIMENSIONS		INDUCTANCE		LEAD FREE

SHAPES AND DIMENSIONS :



UNIT : mm

FEATURES :

- * Low profile.
- * Magnetically shielded low DC resistance .
- * Suitable for large current application.
- * Laptop & Notebook computers.
- * Battery powered equipment.
- * DC/DC converters.
- * Digital 、 Cameras 、 Scanners, CD-ROM & DVD.

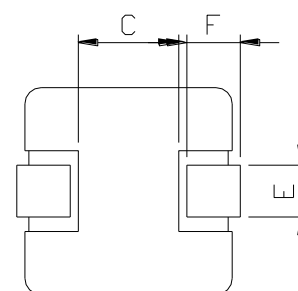
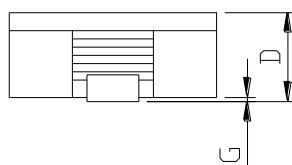
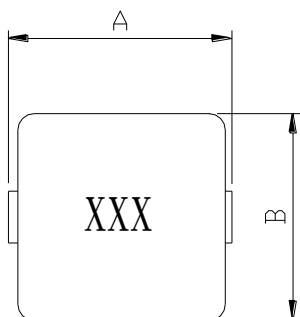

A=12.8±0.7 B=12.8±0.5 C=5.0 Ref. D=7.50 Max. E=3.3±0.5 F=1.9±0.5 G=0.2 Max. UNIT : mm

RECOMMENDED PATTERNS

H= 10.0 I= 4.50 J= 4.50

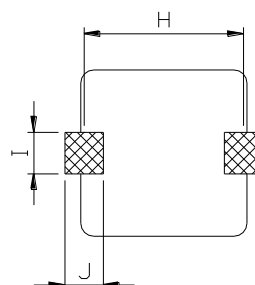

UNIT : mm

SEP1207E SERIES~ High Current SMD Power Inductors



SPECIFICATION TABLE

PART NUMBER	INDUCTANCE (μH)	I _{sat} (A) (Max.)	I _{rms} (A) (Δt) 40°C (Max.)	DCR (m Ω) (Max.)	Test Freq. (KHz)
SEP1207E-R50M-LF	0.50 \pm 20%	45	40	1.00	100KHz/1V
SEP1207E-1R0M-LF	1.00 \pm 20%	35	30	1.50	100KHz/1V
SEP1207E-1R5M-LF	1.50 \pm 20%	28	23	2.50	100KHz/1V
SEP1207E-1R8M-LF	1.80 \pm 20%	23	20	2.50	100KHz/1V

- Inductance measured at 100 kHz, 0.1 V_{rms} .
- I_{sat} : DC current at which the inductance drops 20% (typ) from its value without current.
- I_{rms} : Average current for a 40°C temperature rise above 25°C ambient.
- Operating temperature range -55°C to +125°C ,
- Electrical specifications at 20°C .

PACKAGING SPECIFICATION

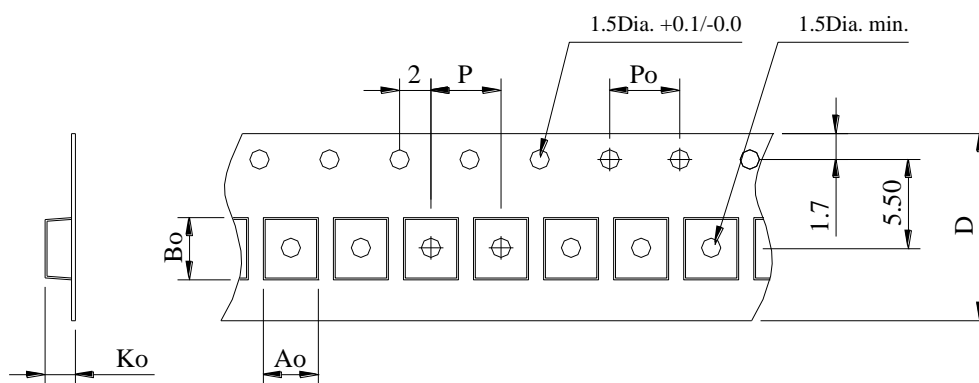

STAYLE	Q'TY (PCS)	DIMENSIONS (m/m)					
		Ao	Bo	Ko	P	Po	D \pm 0.3
13"	500	14.2	13.5	7.6	20	4.0	24