

## RCB1618P SERIES~ Through Hole Power Inductors



### PART NUMBERING SYSTEM

<b>RCB</b>	<b>1618P</b>	—	<b>100M</b>	—	<b>LF</b>
TYPE	DIMENSIONS		INDUCTANCE		LEAD FREE

**U : UL Tube ; P : PET Tube**

### SHAPES AND DIMENSIONS

UNIT : mm

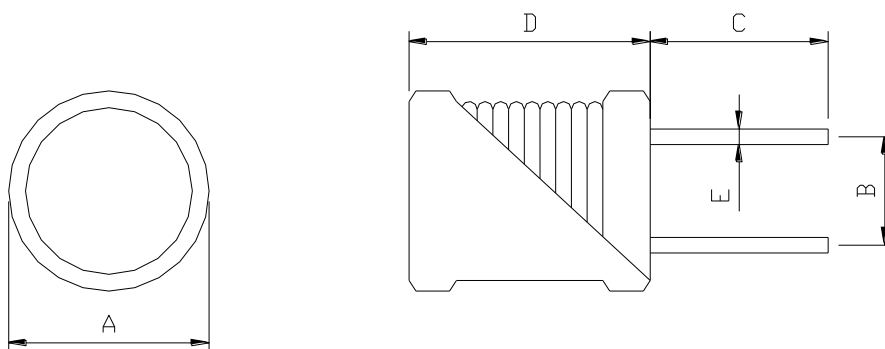

A= 18.0 Max. , B= 10.0±0.5 , C= 15.0±5.0 , D= 20.0 Max. , E= 1.0 Ref.

### STRUCTURAL DIAGRAM :

COMPONENT	MATERIALS
1.Core	Ferrite core
2.Wire	Polyurethane enameled copper wires
3.Lead wire	Tinned copper wires
4.Tube	Heat shrinkable tube, PET or UL
5.Glue	Epoxy resin



## RCB1618P SERIES~ Through Hole Power Inductors



### SPECIFICATION TABLE

PART NUMBER	INDUCTANCE ( $\mu$ H)	DCR (m $\Omega$ ) (max)	IDC ( A ) (max)	TEST FREQ. ( f )
RCB1618-100M-LF	10	9	8.0	1KHz
RCB1618-250K-LF	25	22	6.0	1KHz
RCB1618-500K-LF	50	36	4.0	1KHz
RCB1618-101K-LF	100	90	3.0	1KHz
RCB1618-251K-LF	250	150	2.0	1KHz
RCB1618-501K-LF	500	300	1.2	1KHz
RCB1618-101K-LF	1000	600	1.0	1KHz

1. Inductors Tolerance : K = +/-10% ; M= +/-20%
2. Operating temperature range -40°C to +85°C
3. Electronical specifications at 25°C