



MM4532A SERIES ~ Wire Wound Chip Common Mode Choke



FEATURES

1. Miniature surface mount component – 4.5 × 3.2 mm footprint, 2.8 mm high
2. RoHS-compliant, halogen free. 260°C compatible.

PART NUMBERING SYSTEM

MM	4532A	—	6 0 1	—	LF
TYPE	DIMENSIONS		INDUCTANCE		LEAD FREE

SHAPES AND DIMENSIONS

UNIT : mm

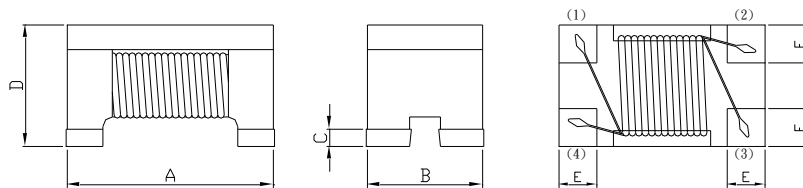
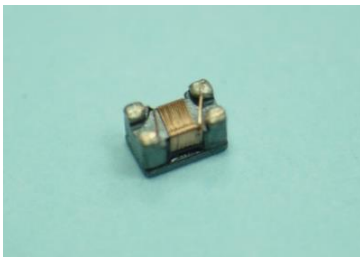

A=4.5±0.2 B=3.2±0.2 C=0.2±0.1 D=2.8±0.2 E = 1.2 Typ. F=1.0 Typ.

Recommended Footprint (mm)

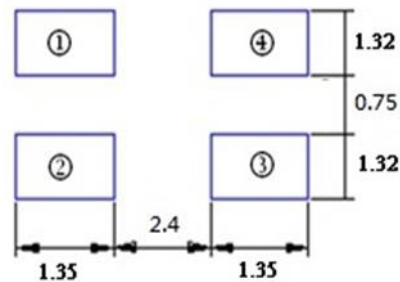

SPECIFICATION TABLE

PART NUMBER	IMPEDANCE(Ω) (at 100MHz/ 25degree)	RATED CURRENT (mA)	DCR (Ω) (Max)	RATED VOLTAGE (Vdc)	INSULATION RESISTANCE (MΩ)
MM4532A-601-LF	600±25%	1,500	0.30	50	10 min.
MM4532A-801-LF	800±25%	1,000	0.30	50	10 min.
MM4532A-102-LF	1,000±25%	1,000	0.40	50	10 min.

Operating Temperature Range : -40°C to +85°C

MM4532A SERIES ~ Wire Wound Chip Common Mode Choke



PACKAGING SPECIFICATION

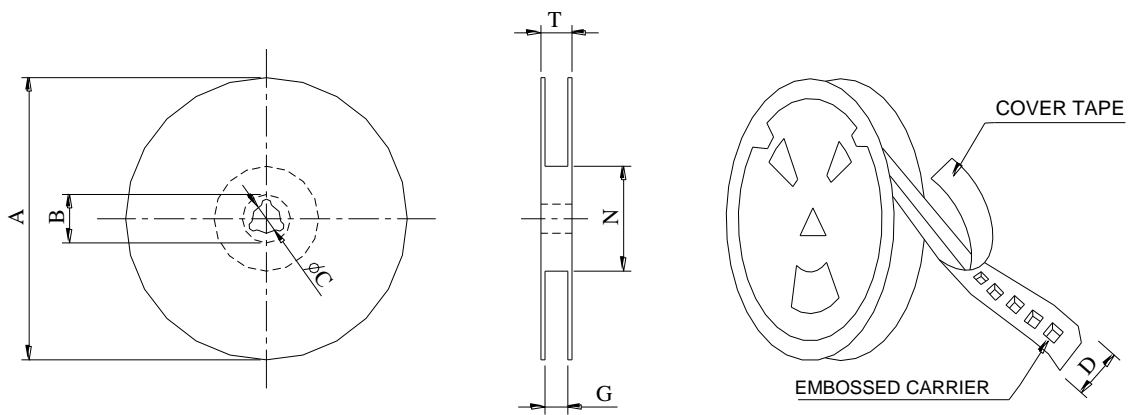

*CARRIER TAPE WIDTH : D

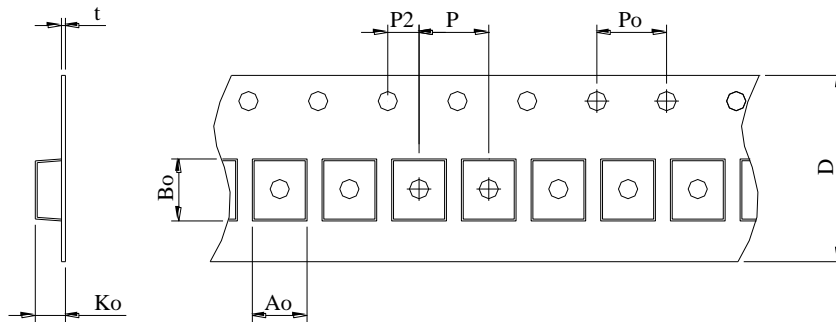

SERIES	STAYLE	Q'TY (PCS)	DIMENSIONS (m/m)								
			A	Ao	Bo	Ko	t	N	P	Po	T
MM4532	178	500	178	3.45	4.90	3.05	0.24	60	8	4	12



MM4532A SERIES ~ Wire Wound Chip Common Mode Choke



Curve

